



**CLIVEPEARCE**  
Now you're moving

3 Bedrooms

House - Semi-Detached

Asking Price

£400,000

Located in

Truro



[www.clivepearceproperty.com](http://www.clivepearceproperty.com)



# Prasow Pyski

Truro | | TR3 6FR



An exceptionally well presented and extended, three bedroom family home with a large sunny landscaped rear garden and ample block paved driveway parking. Desirable and convenient village location.

# Prasow Pyski

£400,000 Freehold



- Three bedrooms
- Landscaped sunny rear garden
- Ample off street driveway parking
- Excellent village location
- Extended
- Excellent interior presentation
- Stylish kitchen with integrated appliances
- UPVC double glazing and mains gas central heating



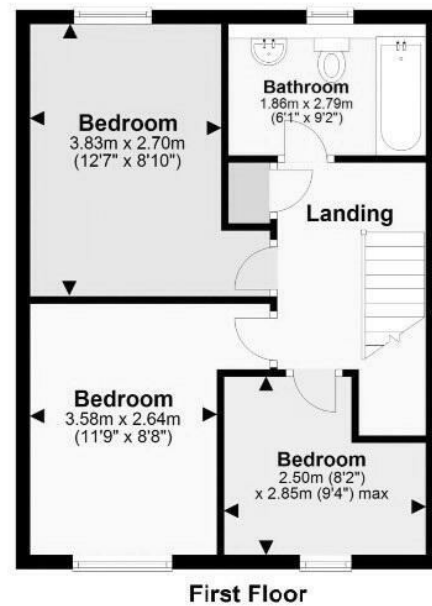

Whilst every attempt has been made to ensure the accuracy of this floor-plan, measurements are approximate and no responsibility is taken for any error or omission. The plan is for representation purposes only and should be used as such by any prospective purchaser.  
Plan produced using PlanIt

## Council Tax Band C

## Local Authority

Agents Note: Whilst every care has been taken to prepare these particulars, they are for guidance purposes only. All measurements are approximate and are for general guidance purposes only and whilst every care has been taken to ensure their accuracy, they should not be relied upon and potential buyers/tenants are advised to recheck the measurements.

Energy Efficiency Rating		
	Current	Potential
Very energy efficient - lower running costs		100
(92 plus) <b>A</b>		
(81-91) <b>B</b>	84	
(69-80) <b>C</b>		
(55-68) <b>D</b>		
(39-54) <b>E</b>		
(21-38) <b>F</b>		
(1-20) <b>G</b>		
Not energy efficient - higher running costs		
England & Wales	EU Directive 2002/91/EC	

31 Lemon Street  
Truro  
Cornwall  
TR1 2LS



**CLIVEPEARCE**  
Now you're moving

hello@clivepearceproperty.com

01872 272622

www.clivepearceproperty.com